



Tube Technologies Inc.
1555 Consumer Circle
Corona, CA 92880
(951) 371-4878
www.ttiexhaust.com

1962 B-body Max Wedge Exhaust System

- 3.0+system . part # B30MAX-NM62

MAX WEDGE MID-PIPE ASSEMBLY

- Head pipes from the factory manifolds
- Max Wedge style H-pipe w/ a 2+Crossover pipe
- 1/2+4-Bolt Flanges
- (2) 2+3/8+Heavy-Duty U-bolt Clamps
- (4) 3+3/8+Heavy-Duty U-bolt Clamps
- (4) 1/16+4-Bolt Gaskets w/ 3+I.D. hole
- (2) 1/2+4-Bolt Blocking Plates

Includes hardware necessary for the installation.

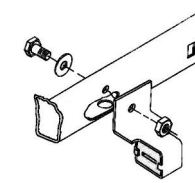
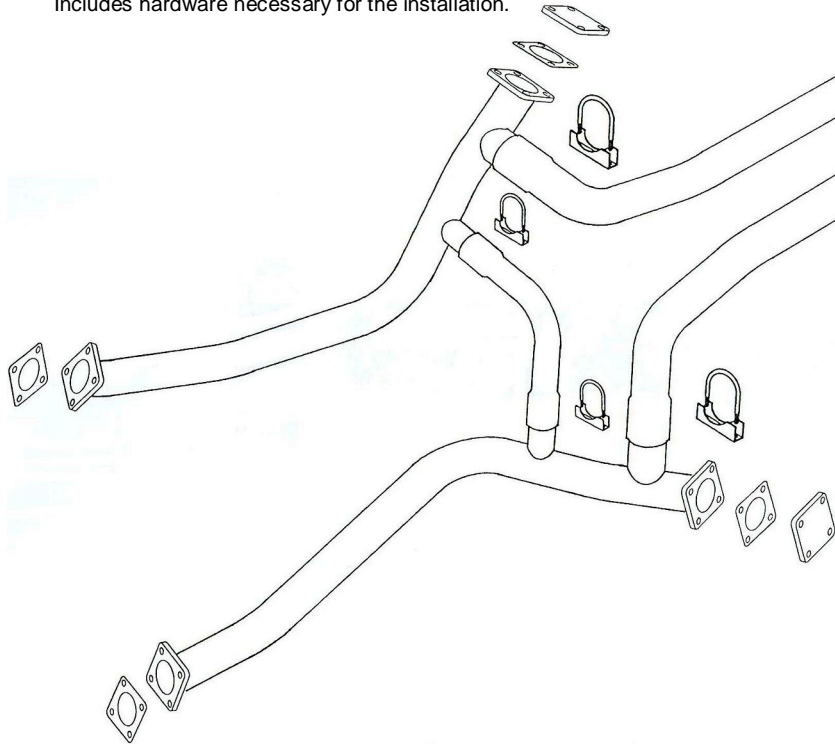

O.E. STYLE TAILPIPE HANGER RECEPTACLES

- Included with Tailpipes.
- Includes Hardware
 - Part # TPH-AB2530

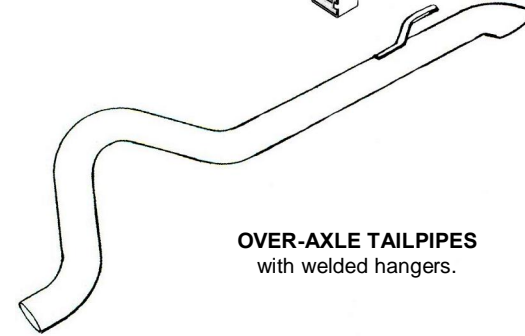

OVER-AXLE TAILPIPES
with welded hangers.

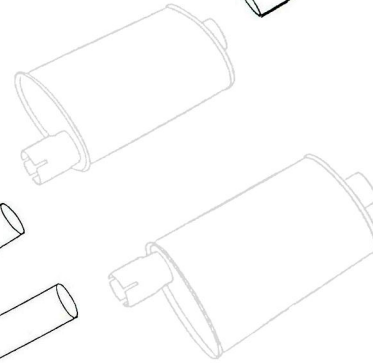

MUFFLERS

Opting to use mufflers other than Dynomax Super Turbos may require modification to the muffler slips, (cutting & welding) for proper fit and alignment due to the muffler case length and width differences.

System designed using Dynomax Super Turbo mufflers

- 3.0+(23+overall length) # 17793

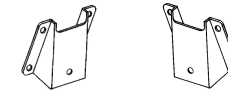

MUFFLER BODY BRACKETS

- Included with system.
- Includes Hardware
 - Part # E2530BB-2

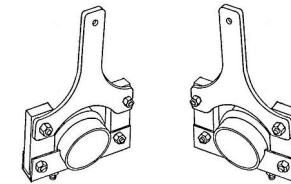

Passenger-side Driver-side

MUFFLER HANGERS

- Included with system.
- 2.5+ Part # MH-B25HA
 - 3.0+Part # MH-B30HA